

HDC16-9-E004-L47N ✓ ACTIVE

DEUTSCH HD, DEUTSCH HD10

TE Internal #: HDC16-9-E004-L47N

TE Internal Description: DUST CAP, 9P, REC, BLK, LANYARD, HD10

Receptacle Dust Caps — DEUTSCH HD10

[View on TE.com >](#)

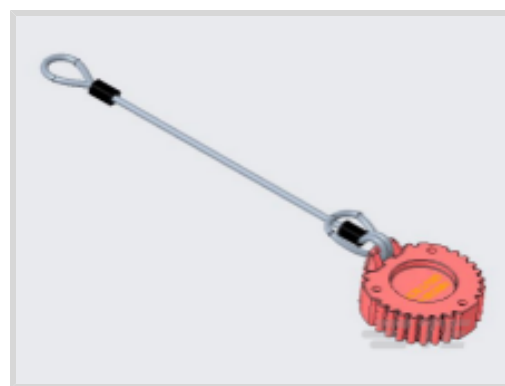

All Receptacle Dust Caps — DEUTSCH HD10 (12)

Product Compliance

[For compliance documentation, visit the product page on TE.com>](#)

EU RoHS Directive 2011/65/EU	Compliant
EU ELV Directive 2000/53/EC	Compliant
China RoHS 2 Directive MIIT Order No 32, 2016	No Restricted Materials Above Threshold
EU REACH Regulation (EC) No. 1907/2006	Current ECHA Candidate List: JUNE 2023 (235) Candidate List Declared Against: JAN 2023 (233) Does not contain REACH SVHC
Halogen Content	Not Low Halogen - contains Br or Cl > 900 ppm.
Solder Process Capability	Not reviewed for solder process capability

Product Compliance Disclaimer

This information is provided based on reasonable inquiry of our suppliers and represents our current actual knowledge based on the information they provided. This information is subject to change. The part numbers that TE has identified as EU RoHS compliant have a maximum concentration of 0.1% by weight in homogenous materials for lead, hexavalent chromium, mercury, PBB, PBDE, DBP, BBP, DEHP, DIBP, and 0.01% for cadmium, or qualify for an exemption to these limits as defined in the Annexes of Directive 2011/65/EU (RoHS2). Finished electrical and electronic equipment products will be CE marked as required by Directive 2011/65/EU. Components may not be CE marked. Additionally, the part numbers that TE has identified as EU ELV compliant have a maximum concentration of 0.1% by weight in homogenous materials for lead, hexavalent chromium, and mercury, and 0.01% for cadmium, or qualify for an exemption to these limits as defined in the Annexes of Directive 2000/53/EC (ELV). Regarding the REACH Regulation, the information TE provides on SVHC in articles for this part number is based on the latest European Chemicals Agency (ECHA) 'Guidance on requirements for substances in articles' posted at this URL: <https://echa.europa.eu/guidance-documents/guidance-on-reach>

Compatible Parts



TE Part # CAT-H3910-CH8172
DEUTSCH HD10 Housings



TE Part # HD10-9-96P-N005
SQ FG REC ASM

Also in the Series | DEUTSCH HD

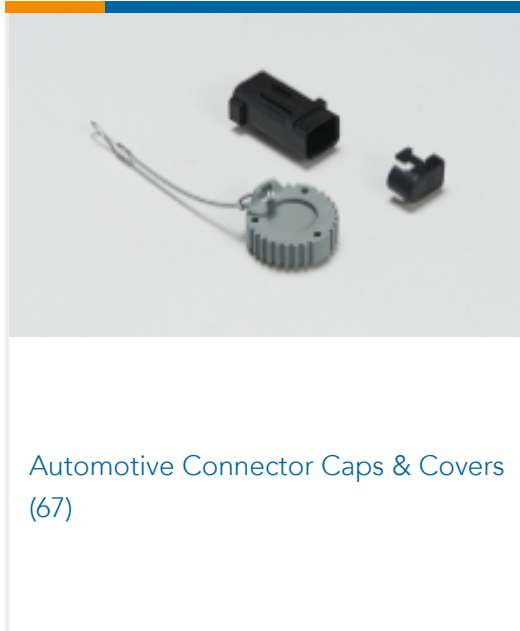

Automotive Connector Caps & Covers
(67)

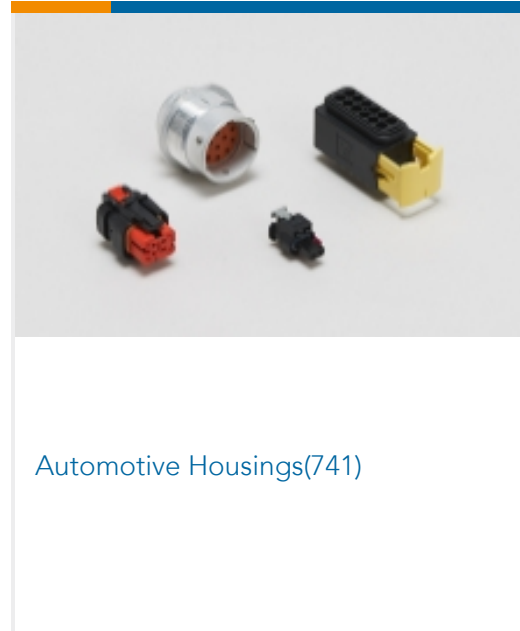

Automotive Housings(741)

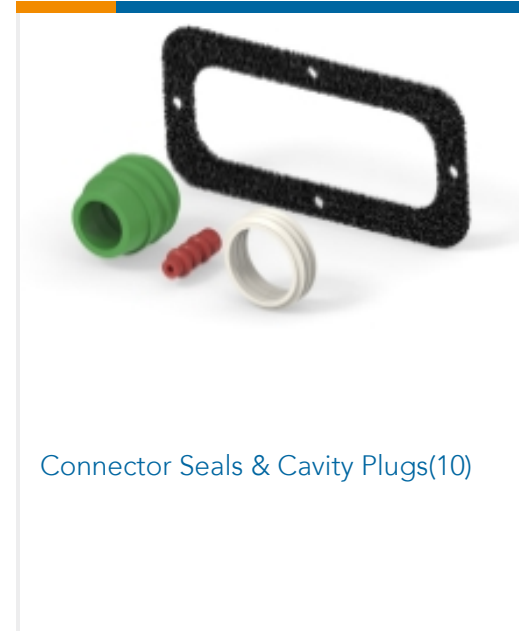

Connector Seals & Cavity Plugs(10)

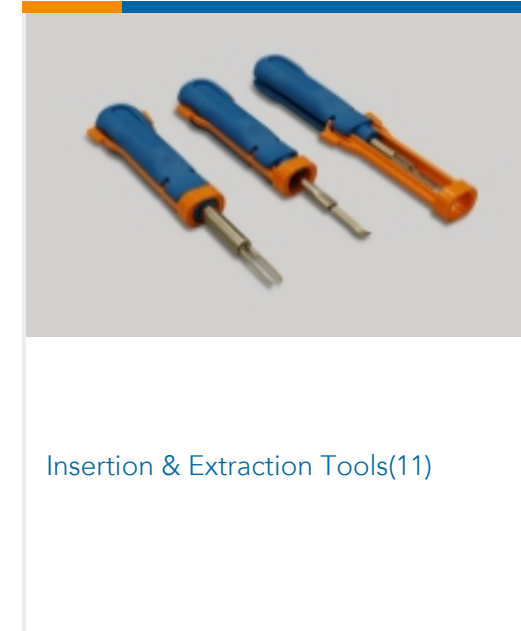

Insertion & Extraction Tools(11)

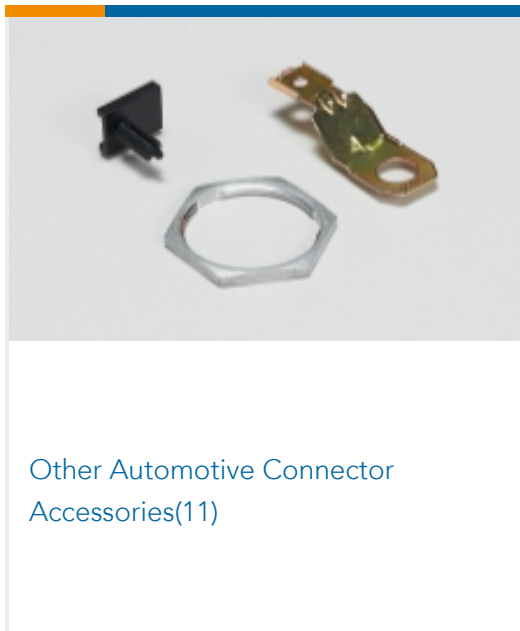

Other Automotive Connector
Accessories(11)



PCB Headers & Receptacles(1)

Also in the Series | DEUTSCH HD10



Automotive Connector Caps & Covers
(34)

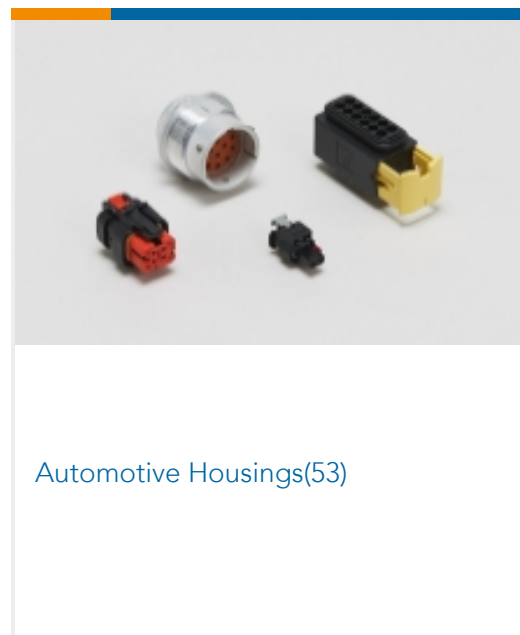

Automotive Housings(53)



PCB Headers & Receptacles(1)

Customers Also Bought

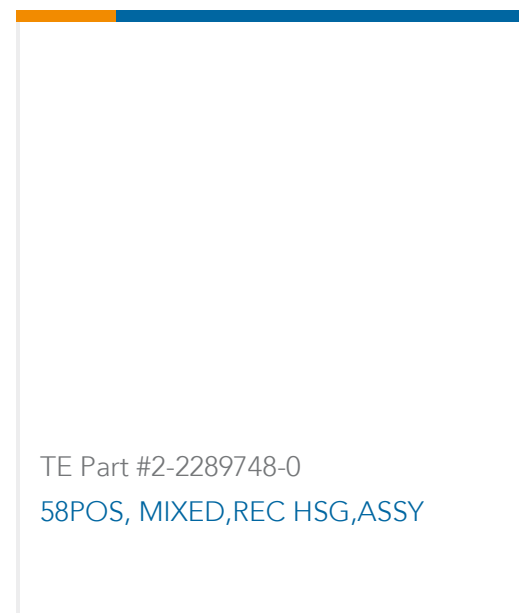

Documents

Product Drawings

DUST CAP, 9P, REC, BLK, LANYARD, HD10

English

CAD Files

3D PDF

3D

Customer View Model

[ENG_CVM_CVM_HDC16-9-E004-L47N_A.2d_dxf.zip](#)

English

Customer View Model

[ENG_CVM_CVM_HDC16-9-E004-L47N_A.3d_igs.zip](#)

English

Customer View Model

[ENG_CVM_CVM_HDC16-9-E004-L47N_A.3d_stp.zip](#)

English

By downloading the CAD file I accept and agree to the [Terms and Conditions](#) of use.

Datasheets & Catalog Pages



CONNECTOR SELECTOR

English

Product Specifications

Application Specification

English